

### READ AND FOLLOW ALL SAFETY INSTRUCTIONS! SAVE THESE INSTRUCTIONS AND DELIVER TO OWNER AFTER INSTALLATION

- To reduce the risk of death, personal injury or property damage from fire, electric shock, falling parts, cuts/abrasions, and other hazards please read all warnings and instructions included with and on the fixture box and all fixture labels.
- Before installing, servicing, or performing routine maintenance upon this equipment, follow these general precautions.
- Installation and service of luminaires should be performed by a **qualified licensed electrician**.
- Maintenance of the luminaires should be performed by person(s) familiar with the luminaires' construction and operation and any hazards involved. Regular fixture maintenance programs are recommended.
- It will occasionally be necessary to clean the outside of the refractor/lens. Frequency of cleaning will depend on ambient dirt level and minimum light output which is acceptable to user. Refractor/lens should be washed in a solution of warm water and any mild, non-abrasive household detergent, rinsed with clean water and wiped dry. Should optical assembly become dirty on the inside, wipe refractor/lens and clean in above manner, replacing damaged gaskets as necessary.
- **DO NOT INSTALL DAMAGED PRODUCT!** This luminaire has been properly packed so that no parts should have been damaged during transit. Inspect to confirm. Any part damaged or broken during or after assembly should be replaced.
- If the lamp is marked (Hg) it contains Mercury. Follow all disposal laws. For more information on how to recycle LED electronic product please visit [www.epa.gov](http://www.epa.gov).
- These instructions do not purport to cover all details or variations in equipment nor to provide every possible contingency to meet in connection with installation, operation, or maintenance. Should further information be desired or should particular problems arise which are not covered sufficiently for the purchaser's or owner's purposes, this matter should be referred to Acuity Brands Lighting, Inc.



#### WARNING RISK OF ELECTRIC SHOCK

- Disconnect or turn off power before installation or servicing.
- Verify that supply voltage is correct by comparing it with the luminaire label information.
- Make all electrical and grounded connections in accordance with the National Electrical Code (NEC) and any applicable local code requirements.
- All wiring connections should be capped with UL approved recognized wire connectors.



#### WARNING RISK OF BURN

- Allow lamp/fixture to cool before handling. Do not touch hot lens, lamp, guard, or enclosure.
- Do not exceed maximum wattage marked on luminaire label.
- Follow all lamp manufacturer's warnings, recommendations and restrictions on lamp operation including but not limited to: ballast type, burning position, replacement, and recycling.



#### WARNING RISK OF INJURY

- Wear gloves and safety glasses at all times when removing luminaire from carton, installing, servicing or performing maintenance.
- Avoid direct eye exposure to the light source while it is on.



#### WARNING RISK OF INJURY

- Keep combustible and other materials that can burn away from lamp/lens.
- Do not operate in close proximity to persons, combustible materials or substances affected by heat or drying.



### WARNING RISK OF PRODUCT DAMAGE

---

- Never connect components under load.
- Do not mount or support these fixtures in a manner that can cut the outer jacket or damaged wire insulation.
- Never connect an LED product to an unapproved dimmer pack. Contact ABL directly for any dimmers not specifically recommended for the product.
- Unless individual product specifications deem otherwise: Allow for some volume of airspace around fixture. Avoid covering LED fixtures with insulation, foam, or other material that will prevent convection or conduction cooling.
- Unless individual product specifications deem otherwise: Maximum ambient temperature is 90°C. Do not operate fixture at temperatures higher than this.
- Unless individual product specifications deem otherwise: Never mount in places where fixture will be exposed to rain, high humidity, extreme temperature changes, or restricted ventilation.
- LED products are Polarity Sensitive. Ensure proper Polarity before installation. • Electrostatic Discharge (ESD): ESD can damage LED fixtures. Personal ground-ing equipment must be worn during all installation or servicing of the unit.
- Do not touch individual electrical components as this can cause ESD, shorten lamp life, or alter performance.
- There are no user-serviceable parts inside the unit. Do not rewire, reconfigure, or modify the unit or attempt any repairs yourself. Additionally, field replacement of the LED assembly or lamps is not allowed by UL standards at this time. In the unlikely event, your unit may require service, stop using the unit immediately and contact an ABL representative.

All luminaires that contain electronic devices that generate frequencies above 9kHz from any component within the luminaire comply with one of the following Part 15 of the FCC Rules. Operation is subject to the following two conditions:

- (1) This device may not cause harmful interference
- (2) This device must accept any interference received, including interference that may cause undesired operation.

This device complies with Part 18 of the FCC Rules but may cause interference with cordless and cell phones, radios, televisions, and other electronic devices. To correct the problem move the device away from the luminaire or plug into a different outlet. This product may cause interference to radio equipment and should not be installed near maritime safety communications equipment or other critical navigation or communications equipment operating between 0.45-30MHz.

Failure to follow any of these instructions could void product warranties. For a complete listing of product Terms and Conditions, please visit [www.acuitybrands.com](http://www.acuitybrands.com).

## SAFETY PRECAUTIONS WARNINGS



Risk of fire or electric shock. Basic safety precautions should always be followed when using electrical equipment. This product must be installed in accordance with the applicable installation code by a person familiar with the construction and operation of the product and the hazards involved.



Disconnect power to all circuits before wiring fixture.  
Install in accordance with all national, state, and local codes.  
Do not connect to an ungrounded supply.  
Read all fixture markings and labels to ensure the correct installation of the fixture.

---

## CAN ICES-005 (A) / NMB-005 (A)

### FCC Compliance Statement

This device complies with part 15 of the FCC Rules. Operation is subject to the following two conditions: (1) This device may not cause harmful interference, and (2) this device must accept any interference received, including interference that may cause undesired operation. This equipment has been tested and found to comply with the limits for a Class A digital device, pursuant to part 15 of the FCC Rules. These limits are designed to provide reasonable protection against harmful interference when the equipment is operated in a commercial environment. This equipment generated, uses, and can radiate radio frequency energy and, if not installed and used in accordance with the instruction manual, may cause harmful interference to radio communications. Operation of this equipment in a residential area is likely to cause harmful interference in which case the user will be required to correct the interference at his own expense.

### ISED Canada Statement

This class A lighting equipment complies with innovation, Science and Economic Development (ISED) Canada Standard for radio interference-causing equipment ICES-005, 5th edition.

### Déclaration pour ISDE Canada

Ce matériel d'éclairage de classe A est conforme avec la norme sur le matériel brouilleur radio NMB-005, 5ième édition, publié par innovation, science et développement économique (ISDE) Canada

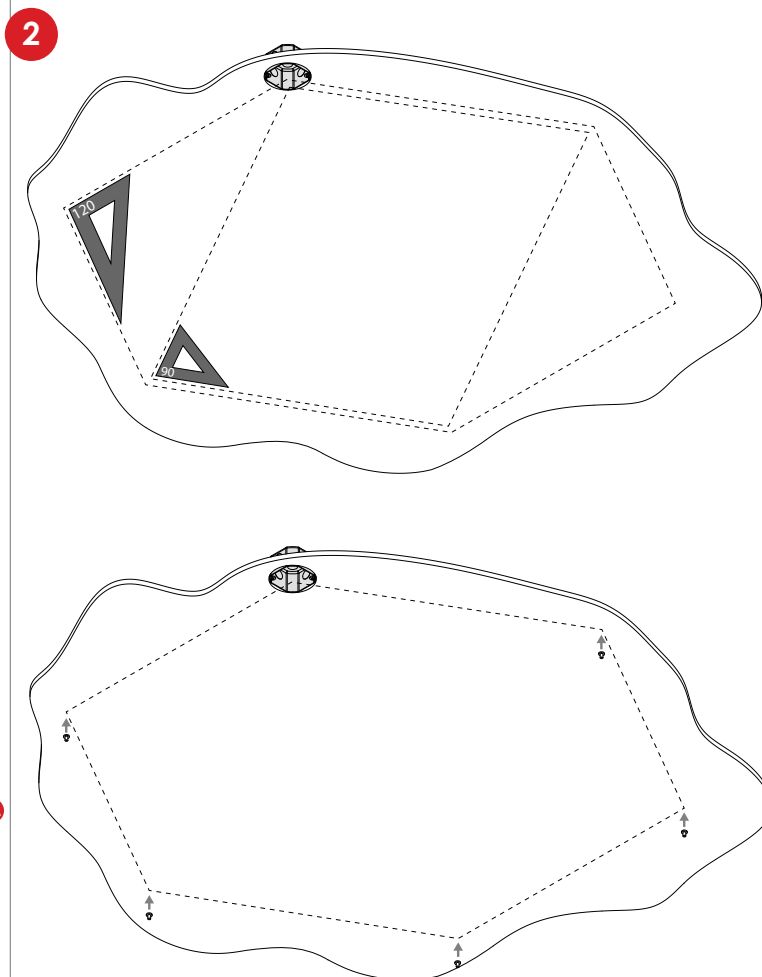
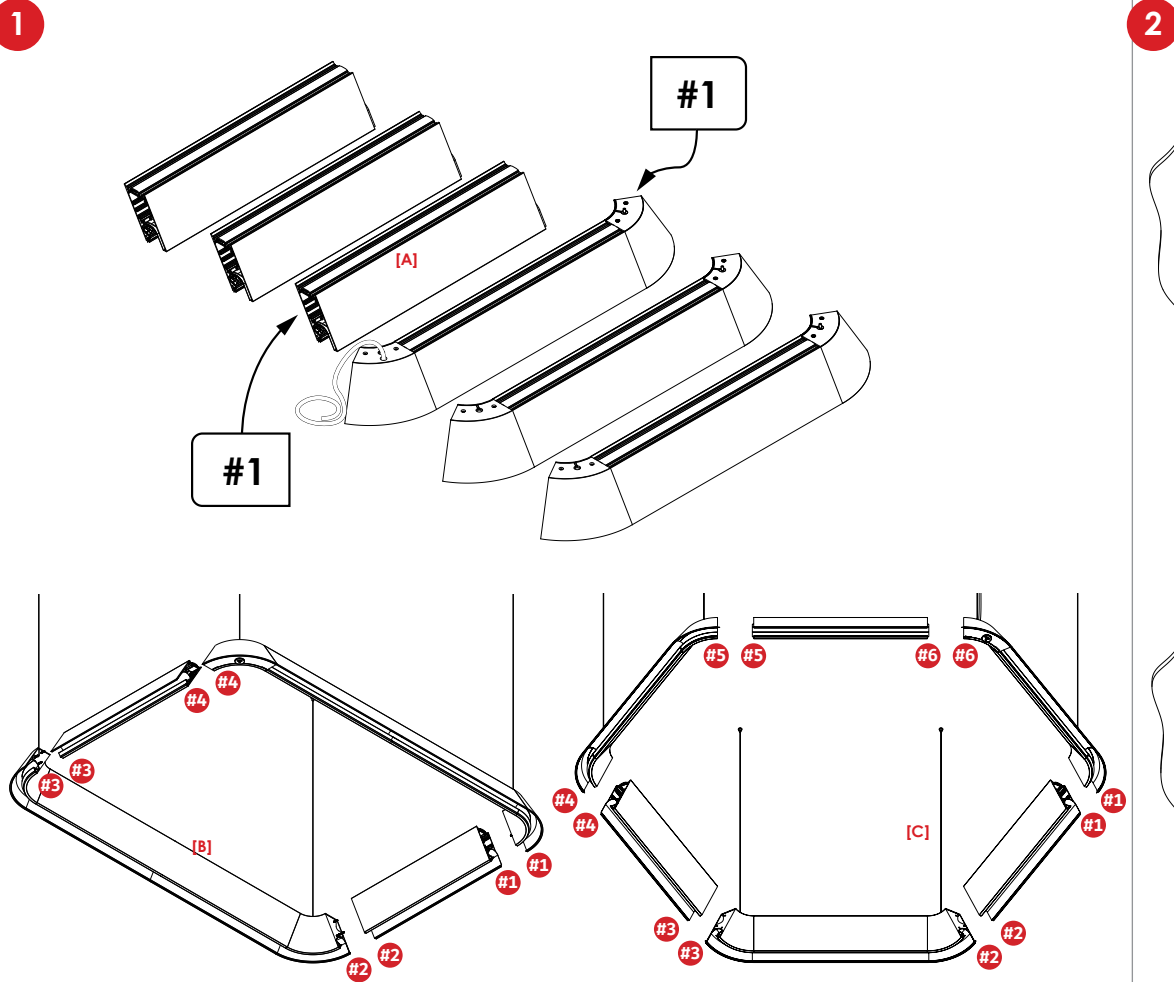

## INSTALLATION STEPS

**WARNING:** Risk of fire and electrical shock - Fixture to be installed by a qualified electrician according to local codes and ordinances.  
**WARNING:** Ensure proper handling of LEDs to limit common problems including: broken connection, loose wiring and damage from electrostatic discharge.

- 1** [A] - Identify the number in the fixture. They need to be placed in a specific order for the fixture to work. The number should match on each end of the parts that are being joined together.  
 [B] - Specific order for an SQ pattern.  
 [C] - Specific order for a HEX pattern.
- 2** [D] - Trace the mounting point in reference to the j-box. You can find the exact dimension in the documentation we send with the fixture. You can find the exact dimensions in the shop drawings sent with the fixture. Refer to page 9 for more information.
- 3** - Install the mounting point on the ceiling.
- 4** - Repeat the step for all the remaining mounting points.  
 - Install the mounting point on the ceiling according to all mounting point marks on the ceiling.  
 - Erase the remaining mark on the ceiling.

**WARNING:** - DO NOT LET GO OF FIXTURE UNTIL IT IS COMPLETELY SECURED AND LEVELED.  
 - DO NOT OVER TORQUE GRIPPERS.  
 - DO NOT CUT AIRCRAFT CABLES! DOING SO WILL VOID WARRANTY.  
 - FOR MORE SEGMENT DIMENSIONS, PLEASE REFER TO DIMENSIONS ON THE NEXT PAGE.  
 - FIXTURE SHOULD BE INSTALLED BY TWO PEOPLE.

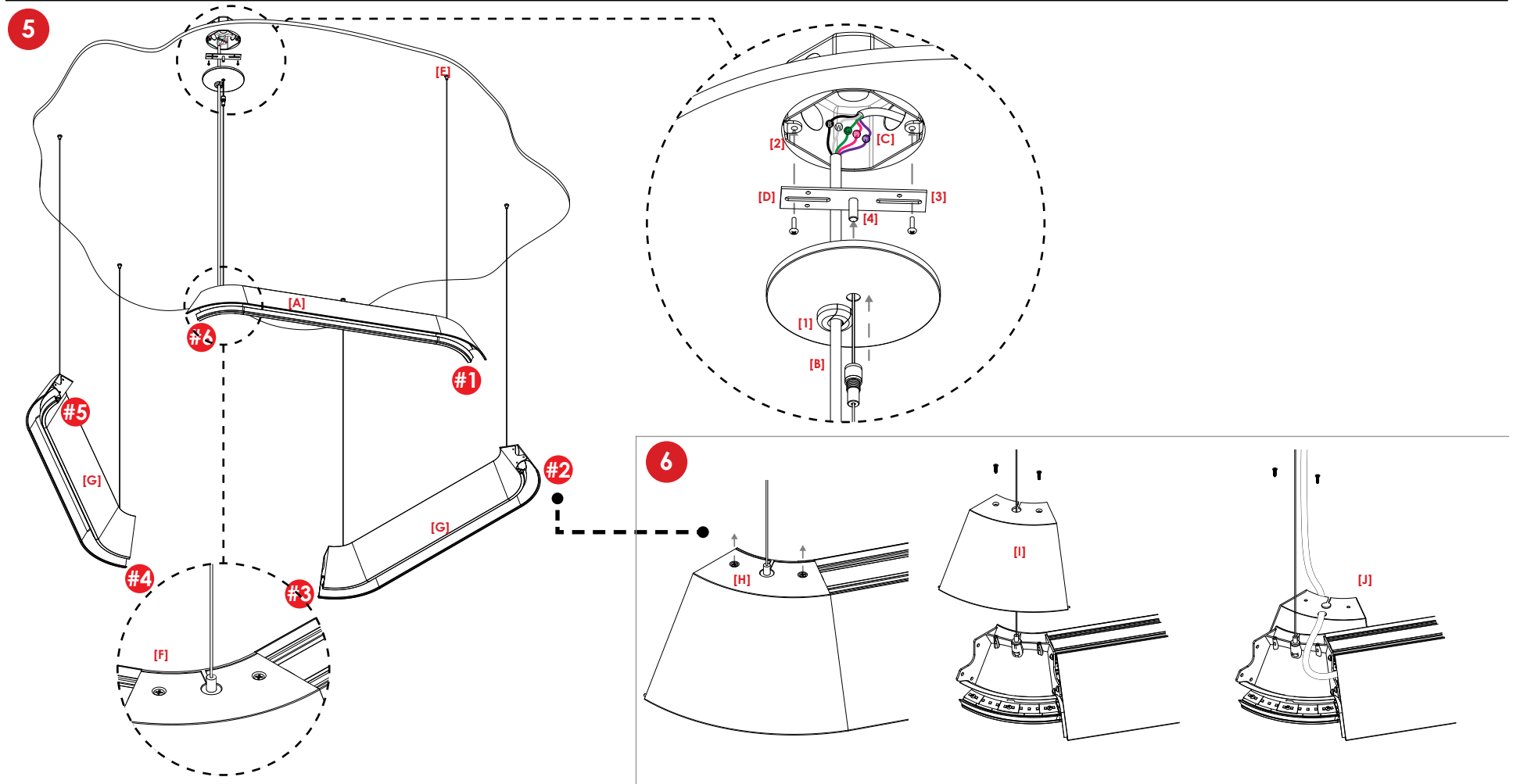

## INSTALLATION STEPS

**WARNING:** Risk of fire and electrical shock - Fixture to be installed by a qualified electrician according to local codes and ordinances.  
**WARNING:** Ensure proper handling of LEDs to limit common problems including: broken connection, loose wiring and damage from electrostatic discharge.

5

- [A] - Install the group with the power cable to the j-box and the first mounting point.
- [B] - Pass the power cable through the canopy clearance hole. [1]
- [C] - Power feed connections: White (neutral), Black (line), Green (ground).  
If dimming required: Pink (0-10V -), Purple (0-10V +). Refer to the wiring diagram.
- [D] - Attach the universal mounting plate to the j-box [2] by attaching cable couplers [3] to bracket bar stud 1/4-20 [4] junction box with screws (by others).
- [E] - Attach second aircraft cable gripper [5] to the 1/4-20 stud that is pre-installed in ceiling grid (by others). Non-power feed canopies are also supplied.
- [F] - Adjust aircraft cable height by pressing the top of the gripper [6], hide the excess aircraft cable inside the fixture channel. Do not let go of the fixture until it is completely secure and leveled.
- [G] - Install the other group that has corners on them.

6

- [H] - Unscrew all endcaps from the corners.
- [I] - Remove them from the fixture and place them somewhere they won't get damaged or scratched.
- [J] - The power cable canopy can't be fully removed from the fixture. You can let it hang on the back of the corner.

**WARNING:** - DO NOT LET GO OF FIXTURE UNTIL IT IS COMPLETELY SECURED AND LEVELED.  
 - DO NOT OVER TORQUE GRIPPERS.  
 - DO NOT CUT AIRCRAFT CABLES! DOING SO WILL VOID WARRANTY.  
 - FOR MORE SEGMENT DIMENSIONS, PLEASE REFER TO DIMENSIONS ON THE NEXT PAGE.  
 - FIXTURE SHOULD BE INSTALLED BY TWO PEOPLE.

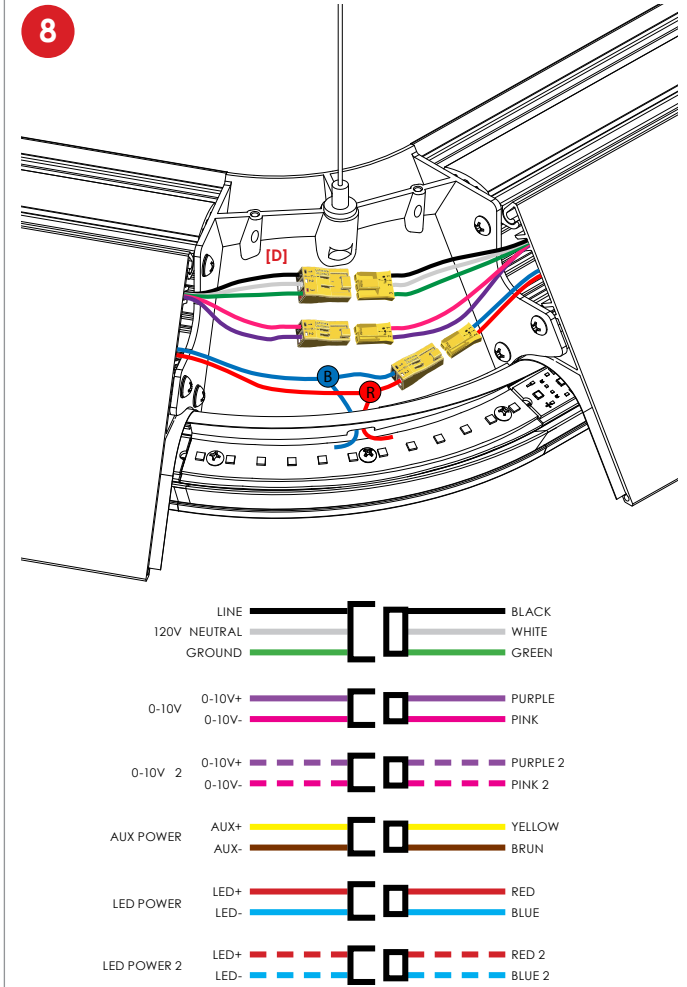
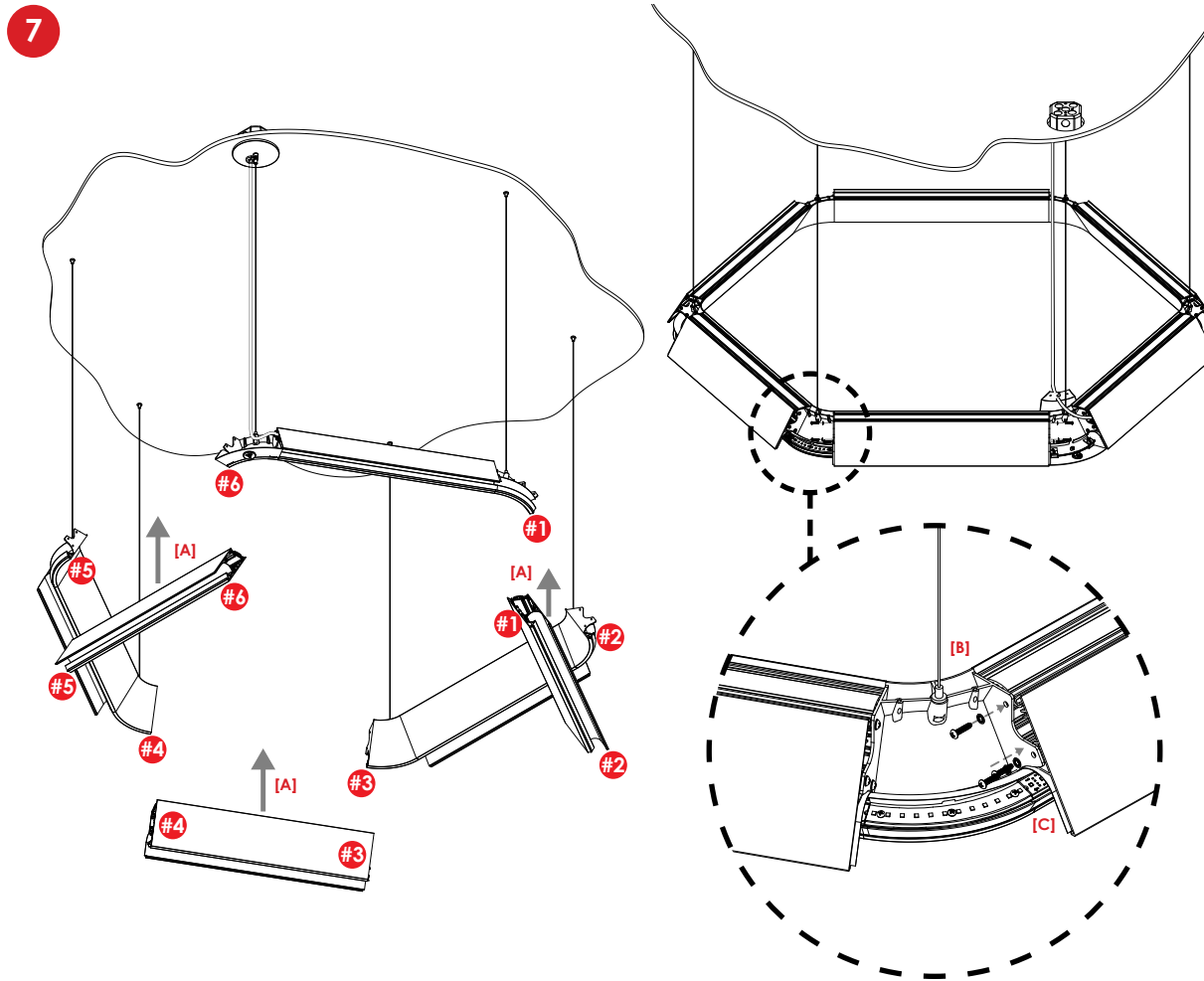

## INSTALLATION STEPS

**WARNING:** Risk of fire and electrical shock - Fixture to be installed by a qualified electrician according to local codes and ordinances.  
**WARNING:** Ensure proper handling of LEDs to limit common problems including: broken connection, loose wiring and damage from electrostatic discharge.

- 7** [A] - Install, one at the time, all the extrusion groups to the corners that are already attached to the ceiling in relation to the number in the extrusion. Keep in mind that the number should match on each end of the parts that are being joined together. (This step could be made on the ground for small fixture before mounting the fixture to the ceiling.)  
 [B] - To do so, screw the two ends of the extrusions to the respective corners. [C] The reflective films in the fixture need to overlap. To do so they need to extend 3/16" off the extrusion on both sides. Take your time on this step because those reflectors are fragile and easily crease. Also, make sure your hands are clean because the reflector can get dirty.

- 8** [D] - Plug all connections around the fixture located in each corner: White (neutral), Black (line), Green (ground). If dimming is required: Purple (0-10V +), Pink (0-10V -). If LED power required: RED (LED +), BLEU (LED -). Refer to the wiring diagram.

**WARNING:** - DO NOT LET GO OF FIXTURE UNTIL IT IS COMPLETELY SECURED AND LEVELED.  
 - DO NOT OVER TORQUE GRIPPERS.  
 - DO NOT CUT AIRCRAFT CABLES! DOING SO WILL VOID WARRANTY.  
 - FOR MORE SEGMENT DIMENSIONS, PLEASE REFER TO DIMENSIONS ON THE NEXT PAGE.  
 - FIXTURE SHOULD BE INSTALLED BY TWO PEOPLE.

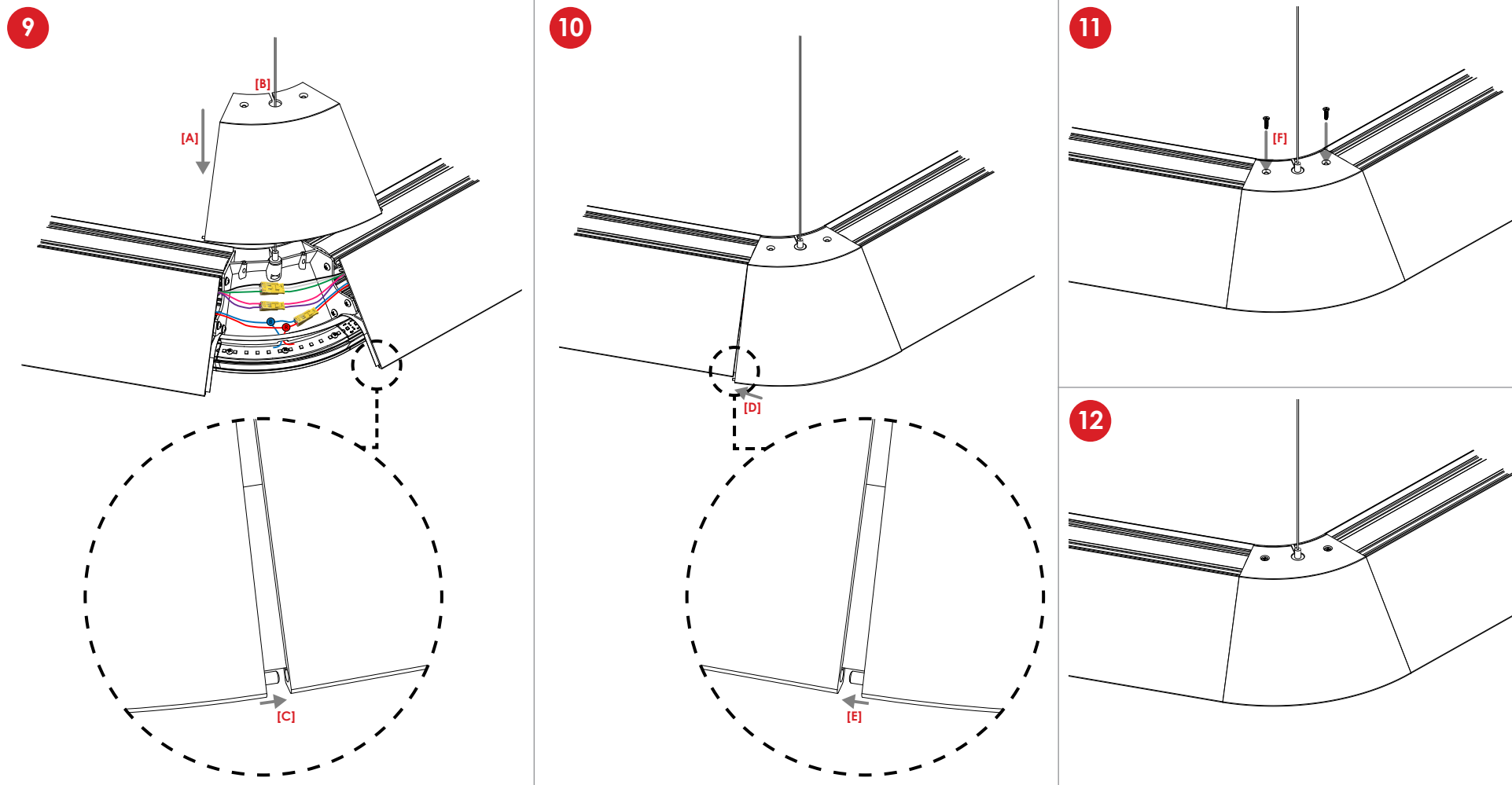

## INSTALLATION STEPS

**WARNING:** Risk of fire and electrical shock - Fixture to be installed by a qualified electrician according to local codes and ordinances.  
**WARNING:** Ensure proper handling of LEDs to limit common problems including: broken connection, loose wiring and damage from electrostatic discharge.

- 9** [A] - Install all the endcaps on the corners of the fixture. If there's an nLight sensor corner, the outer shell won't have a reflector in it. Make sure all lit corners have a reflector. [B] First, pass the aircraft cable and gripper in the hole in the endcap.  
 [C] - Secondly, align one side by putting the alignment pin of the corner in the hole of the extrusion.

- 10** [D] - Align the other side of the corner by putting the alignment pin of the corner in the hole of the other extrusion. [E] It is a tight fit so you may need a bit of force to put it in place.

- 11** [F] - Screw all endcaps of each corner in place.

**WARNING:** - DO NOT LET GO OF FIXTURE UNTIL IT IS COMPLETELY SECURED AND LEVELED.  
 - DO NOT OVER TORQUE GRIPPERS.  
 - DO NOT CUT AIRCRAFT CABLES! DOING SO WILL VOID WARRANTY.  
 - FOR MORE SEGMENT DIMENSIONS, PLEASE REFER TO DIMENSIONS ON THE NEXT PAGE.  
 - FIXTURE SHOULD BE INSTALLED BY TWO PEOPLE.

13

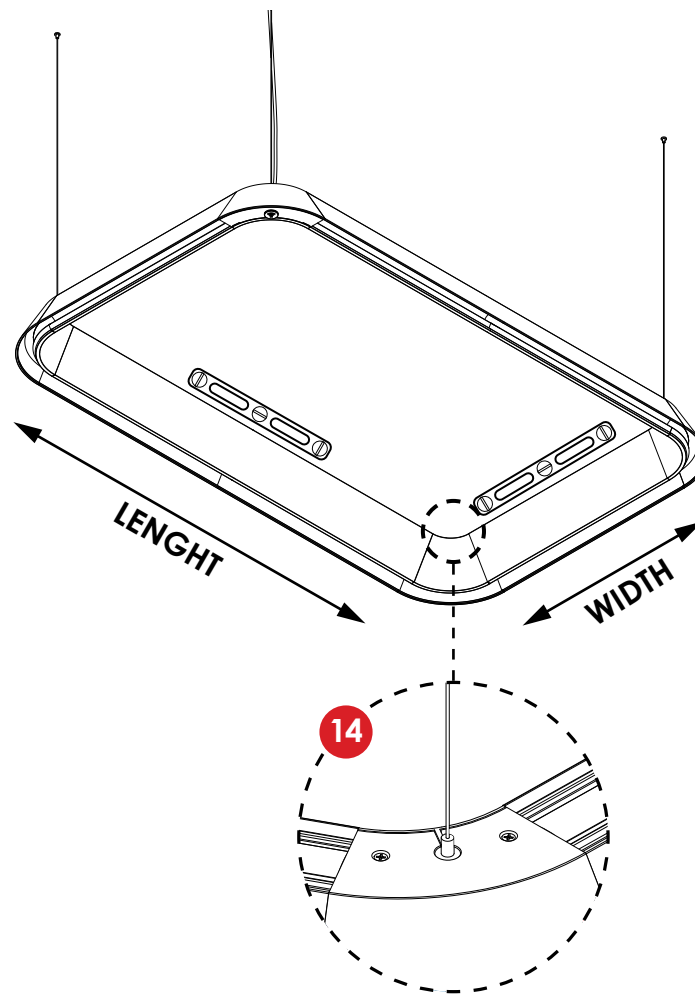
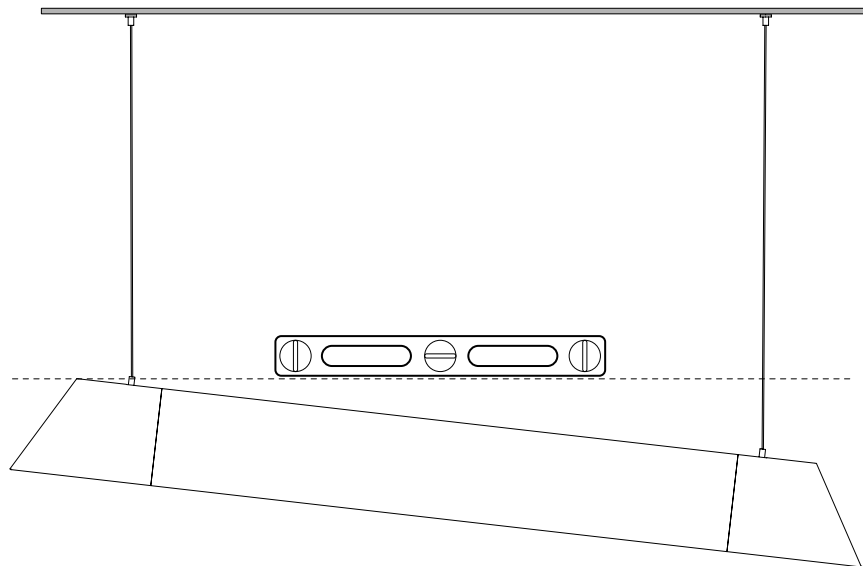

## INSTALLATION STEPS

**WARNING:** Risk of fire and electrical shock - Fixture to be installed by a qualified electrician according to local codes and ordinances.  
**WARNING:** Ensure proper handling of LEDs to limit common problems including: broken connection, loose wiring and damage from electrostatic discharge.

13

- Make sure the fixture is leveled in all directions.

14

- Make sure that all grippers are locked on the fixture and the ceiling location. Do not let go of the fixture until it is completely secure and leveled.

**WARNING:**

- DO NOT LET GO OF FIXTURE UNTIL IT IS COMPLETELY SECURED AND LEVELED.
- DO NOT OVER TORQUE GRIPPERS.
- DO NOT CUT AIRCRAFT CABLES! DOING SO WILL VOID WARRANTY.
- FOR MORE SEGMENT DIMENSIONS, PLEASE REFER TO DIMENSIONS ON THE NEXT PAGE.
- FIXTURE SHOULD BE INSTALLED BY TWO PEOPLE.



## Recommended Mounting Points

Suspension grippers must be placed according to the shop drawings distance and as precisely as possible.

SQ - Square pattern

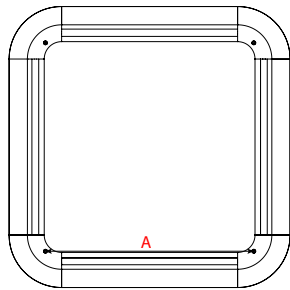

RC - Rectangle pattern

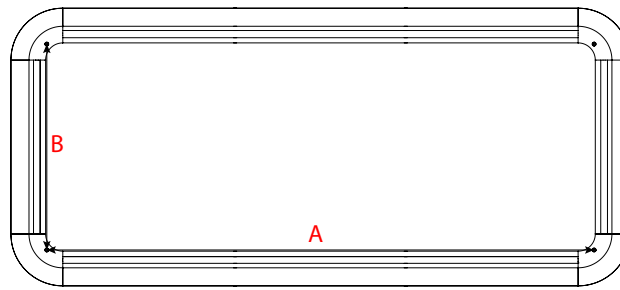

Pentagon pattern

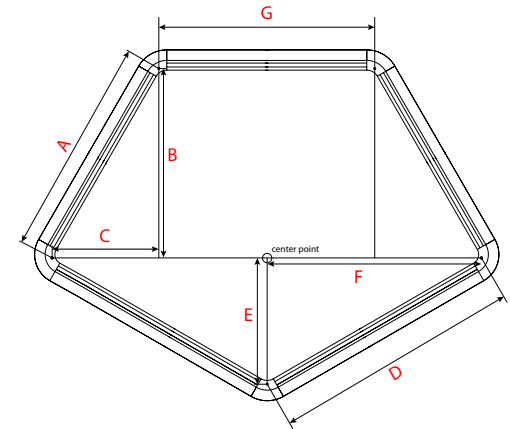

H - Hexagonal pattern

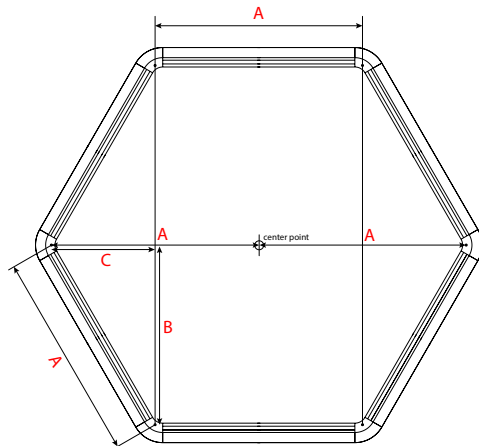

HL - Hexagonal long pattern

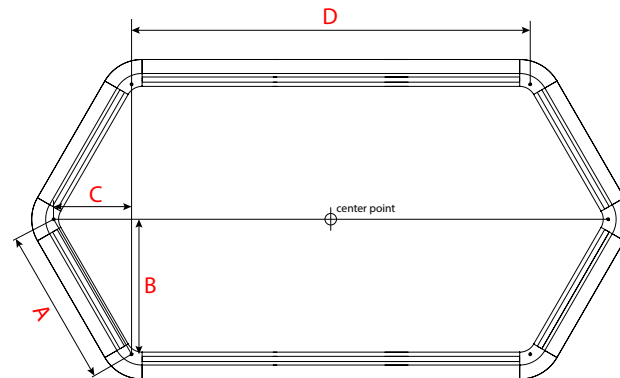

Diamond pattern

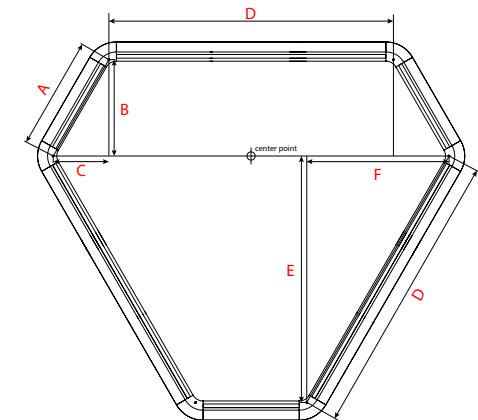

## INSTALLATION STEPS



**WARNING:** Risk of fire and electrical shock - Fixture to be installed by qualified electrician according to local codes and ordinances.

**WARNING:** Ensure proper handling of LEDs to limit common problems including: broken connection, loose wiring and damage from electrostatic discharge.

General Dimension

| NOMINAL RELAY HEXAGONAL DIMENSIONS |                |                           |
|------------------------------------|----------------|---------------------------|
|                                    | TRUE DIMENSION | MOUNTING LENGTH DIMENSION |
| NOMINAL 3'                         | 39.375"        | 28.438"                   |
| NOMINAL 4'                         | 50.375"        | 40.438"                   |
| NOMINAL 5'                         | 62.375"        | 52.438"                   |
| NOMINAL 6'                         | 74.375"        | 64.438"                   |
| NOMINAL 7'                         | 86.375"        | 76.438"                   |
| NOMINAL 8'                         | 98.375"        | 88.438"                   |
| NOMINAL 9'                         | 110.375"       | 100.438"                  |

\*Outside lengths are specifiable to the nearest 0.5ft.  
\*Dimensions in grey are the mounting point lengths..

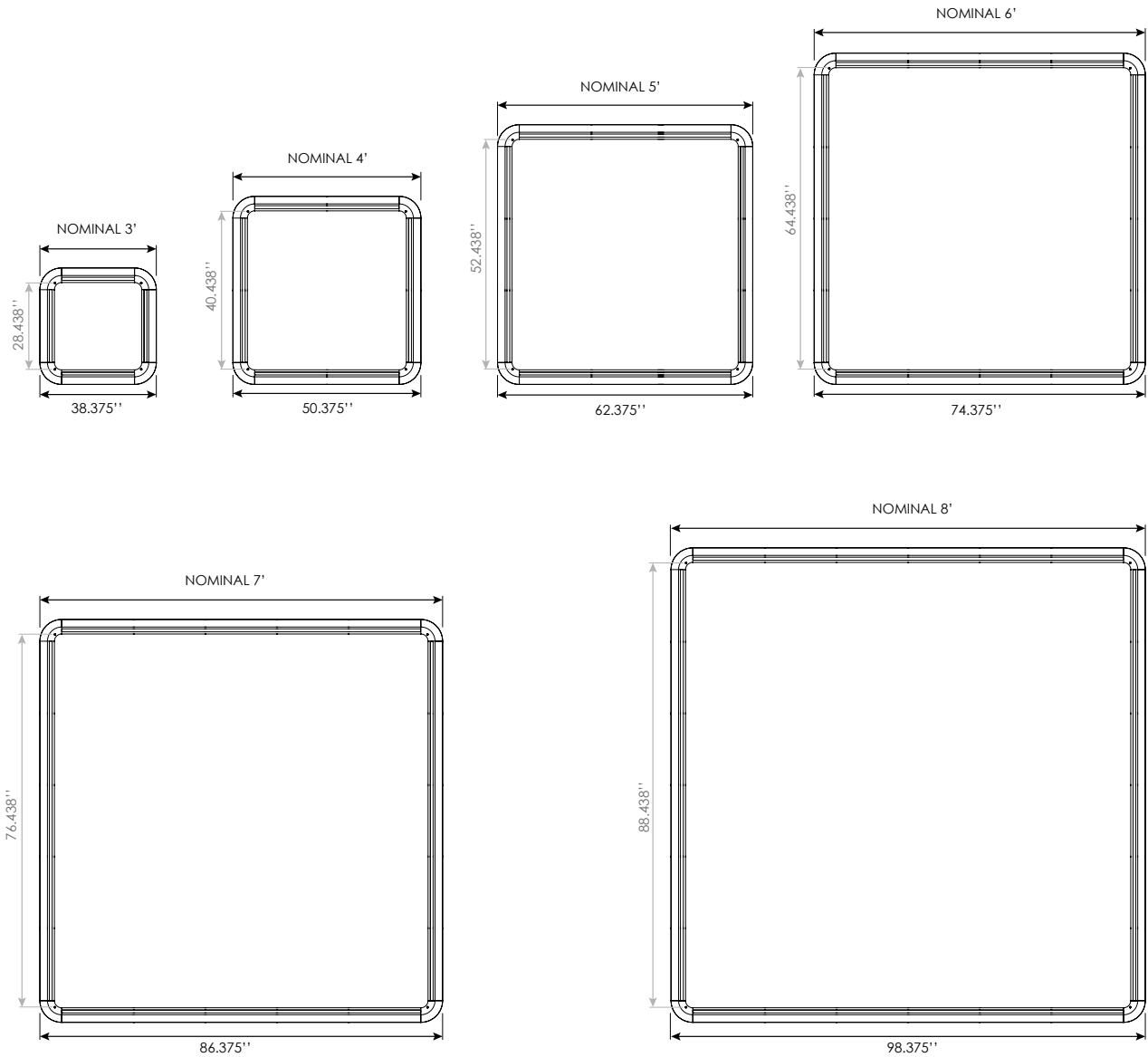

INSTALLATION STEPS

**WARNING:** Risk of fire and electrical shock - Fixture to be installed by qualified electrician according to local codes and ordinances.

**WARNING:** Ensure proper handling of LEDs to limit common problems including: broken connection, loose wiring and damage from electrostatic discharge.

General Dimension

| NOMINAL RELAY HEXAGONAL DIMENSIONS |                       |                      |                               |                               |                               |
|------------------------------------|-----------------------|----------------------|-------------------------------|-------------------------------|-------------------------------|
|                                    | TRUE LENGHT DIMENSION | TRUE WIDTH DIMENSION | MOUNTING LENGTH DIMENSION (A) | MOUNTING LENGTH DIMENSION (B) | MOUNTING LENGTH DIMENSION (C) |
| NOMINAL 5'                         | 63.375"               | 56.875"              | 27.750"                       | 55.500"                       | 48.000"                       |
| NOMINAL 6'                         | 75.375"               | 67.250"              | 33.750"                       | 67.500"                       | 58.438"                       |
| NOMINAL 7'                         | 87.375"               | 77.625"              | 39.750"                       | 79.500"                       | 68.875"                       |
| NOMINAL 8'                         | 99.375"               | 88.000"              | 45.750"                       | 91.500"                       | 79.250"                       |
| NOMINAL 9'                         | 111.375"              | 98.438"              | 51.750"                       | 103.500"                      | 89.625"                       |
| NOMINAL 10'                        | 123.375"              | 108.875"             | 57.750"                       | 115.500"                      | 100.000"                      |
| NOMINAL 11'                        | 135.375"              | 119.250"             | 63.750"                       | 127.500"                      | 110.438"                      |
| NOMINAL 12'                        | 147.375"              | 129.625"             | 69.750"                       | 139.500"                      | 120.875"                      |
| NOMINAL 13'                        | 159.375"              | 140.000"             | 75.750"                       | 151.500"                      | 131.250"                      |
| NOMINAL 14'                        | 171.375"              | 150.438"             | 81.750"                       | 163.500"                      | 141.625"                      |
| NOMINAL 15'                        | 183.375"              | 160.875"             | 87.750"                       | 175.500"                      | 152.000"                      |

\*Outside lengths are specifiable to the nearest 0.5ft.  
\*Dimensions in grey are the mounting point lengths..

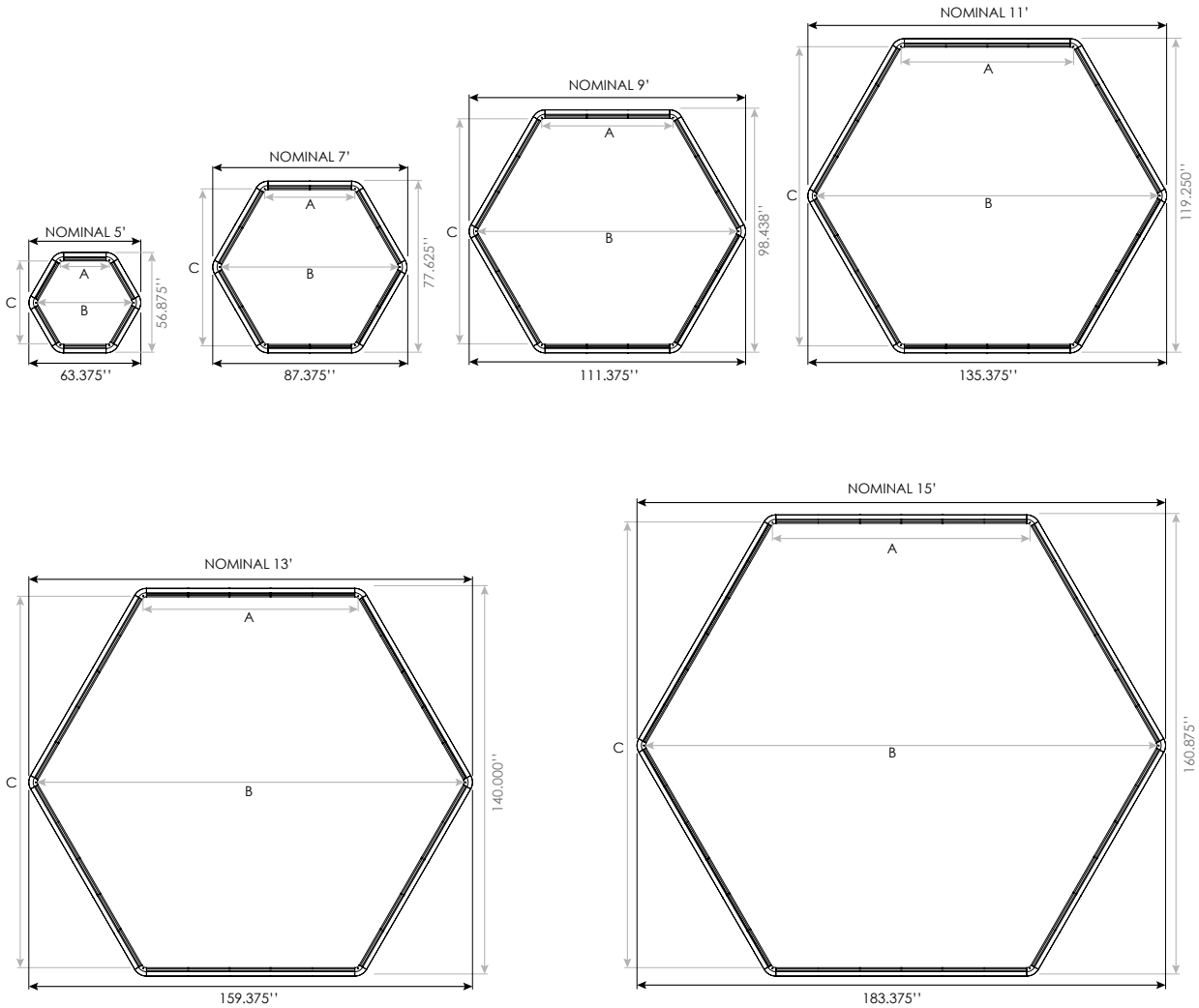

INSTALLATION STEPS

**WARNING:** Risk of fire and electrical shock - Fixture to be installed by qualified electrician according to local codes and ordinances.

**WARNING:** Ensure proper handling of LEDs to limit common problems including: broken connection, loose wiring and damage from electrostatic discharge.